

STATE OF NORTH CAROLINA - ROCKINGHAM COUNTY
I, Bobby Lee Davis, certify that this map was
drawn under my supervision from an actual
survey made under my supervision; that the
error of closure on me calculated by lati-
tudes and departures is 1 / 40000; that the
boundaries not surveyed are shown as broken
lines plotted from information found in
Book..... Page..... that this map
was prepared in accordance with G. S. 47-30
as amended.

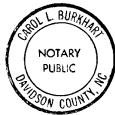

WITNESS my hand and seal this 30th
day of November..... 1990.
Bobby Lee Davis L717
SURVEYOR REG. NO.

STATE OF NORTH CAROLINA - DAVIDSON COUNTY
I, a Notary Public of the county and State aforesaid
certify that Bobby Lee Davis, a registered land
surveyor, personally appeared before me this day and
acknowledged the execution of the foregoing instrument.



WITNESS my hand and official stamp on seal, this 30
day of November..... 1990.
Carol L. Burnhart NOTARY PUBLIC
My Commission Expires March 11, 1992.

OTIS DAVID EVANS, JR.
D.B. 413 PG. 532

IDA EVANS
D.B. 598 PG. 630

OTHA W. GAMMON, et ux
D.B. 617 PG. 226

JENNINGS TRAVIS
D.B. 501 PG. 055

ANDREW OAKS
TAX MAP 8020 1001 43-035

68.71 ACRES (BY D.M.D.)
TAX MAP 8020 1001 23-820
D.B. 705 PG. 355
D.B. 830 PG. 195

OTHA W. GAMMON, et ux
D.B. 617 PG. 226

NORTH CAROLINA
ROCKINGHAM COUNTY
THE FOREGOING CERTIFICATE OF CAROL L. BURNHART, A
NOTARY PUBLIC OF DAVIDSON COUNTY, STATE OF NORTH
CAROLINA IS CERTIFIED TO BE CORRECT.
FILED FOR REGISTRATION AT 9:27 O'CLOCK A.M. ON THE
4th DAY OF DECEMBER, 1990 AND RECORDED IN BOOK 28
PAGE 245.

RAMONA H. PAGE, REGISTER OF DEEDS
By: Richard A. Anderson, Asst. R.D.

NOTE: NO PUBLISHED N.C.G.S. HORIZONTAL
CONTROL WITHIN 2,000 FEET.

SURVEYED BY
DAVIS-MARTIN-POWELL & ASSOC., Inc.
ENGINEERING - LAND PLANNING - SURVEYING
218 GATEWOOD AVE. SUITE 102
HIGH POINT, NORTH CAROLINA 27282
PH. (810) 880-4821
DATE: NOV. 1990 SCALE: 1"=200' JOB NO. S-31257.03
SURVEYED BY M.S. PLATTED BY M.P., S.S.

APPROVED BY PLANNING DEPT. DATE: 12-4-90
Ray Brown

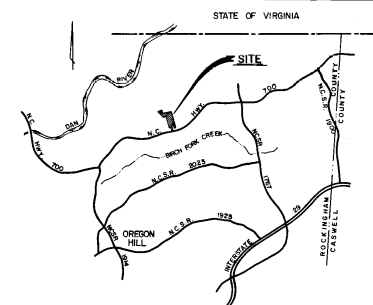

VICINITY MAP
NOT TO SCALE

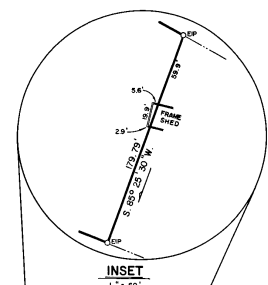

INSET
1" = 60'

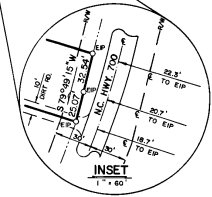

INSET
1" = 60'

PROPERTY OF
FARMERS HOME ADMINISTRATION
RUFFIN TOWNSHIP - ROCKINGHAM COUNTY
NORTH CAROLINA

SCALE: 1" = 200' NOVEMBER 1990 JOB NO. S-31257.03
CONTRACT NO. 60-453-B-1-6001C